

PUNTO eMANUAL

Electrical Equipment

Title	Page
Location of components	1 ➡

55.

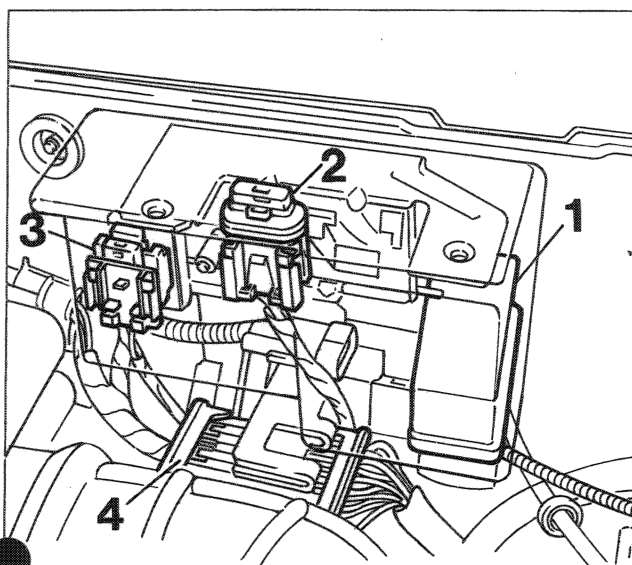

P3M02XL01



FUSE HOLDER BRACKET IN ENGINE BAY

1242 16v engine:

1. Multiple relay
2. 15A fuse protecting fuel injection pump/Lambda probe and fuel injectors
3. 10A fuse protecting anti-lock braking system (A.B.S.)
4. Frong cables/fuel injection cable connection

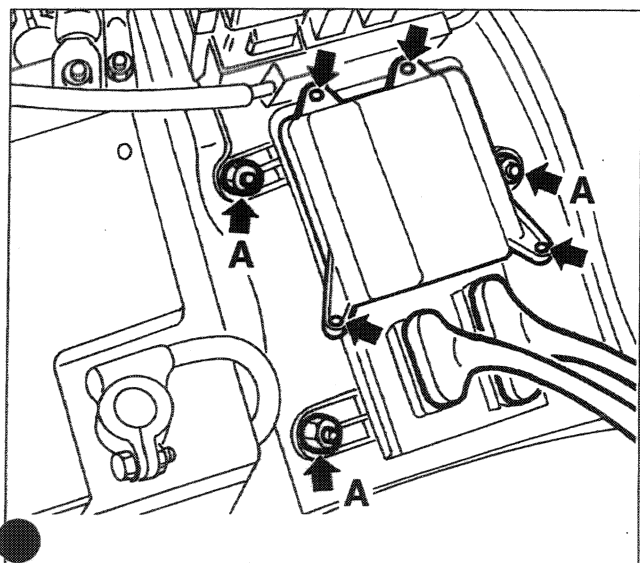

P3M02XL02



FUSE AND RELAY UNIT FOR AIR CONDITIONER ('96 range)

- Undo the 4 screws shown in the figure and remove the cover.

If necessary, remove the control unit:

- Disconnect the two connections.
- Undo the three bolts **A** and remove the control unit.

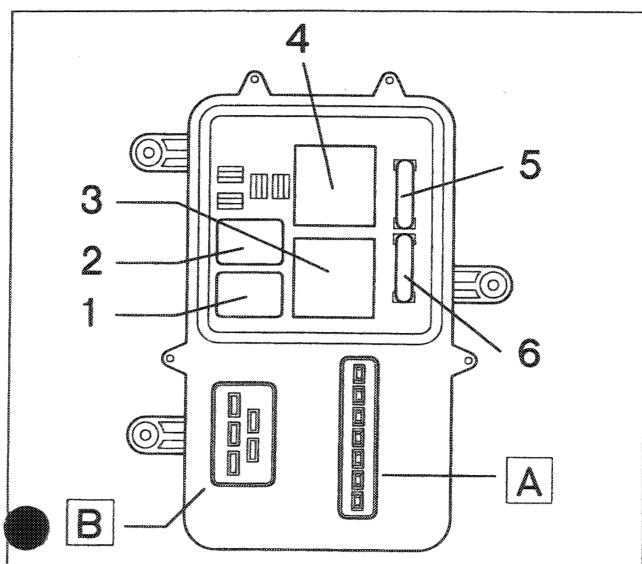

P3M02XL03



1. Engine cooling fan first speed relay
2. Relay for switching on compressor coupling
3. Engine cooling fan second speed relay
4. Timer for engine cooling fan second speed
5. 7.5A fuse for compressor coupling
6. 3A fuse for engine cooling fan second speed

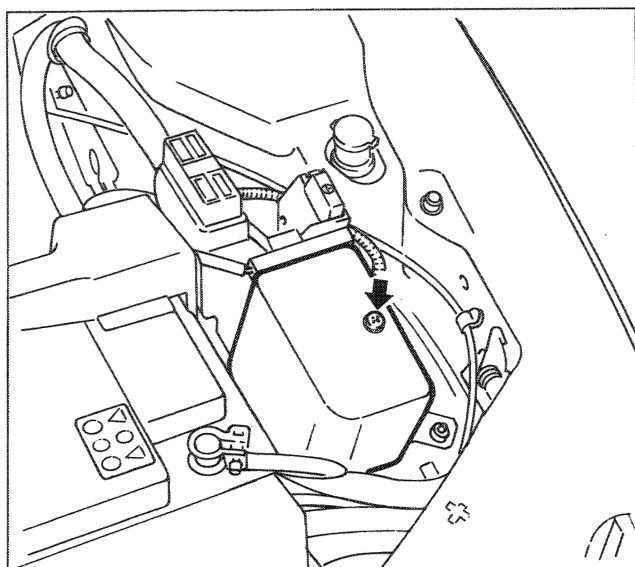

P3M03XL01



FUSES AND RELAYS FOR AIR CONDITIONER ('97 range)



- Undo the screw shown in the figure and remove the cover.

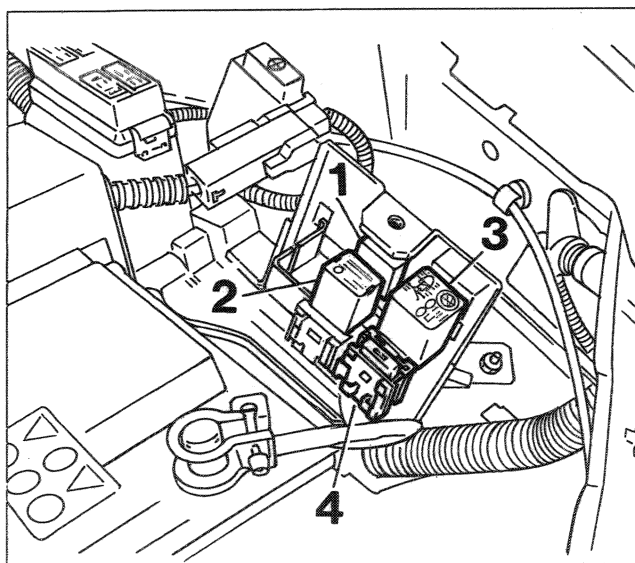

P3M03XL02



1. Engine cooling fan first speed relay
2. Relay for switching on compressor coupling
3. Engine cooling fan second speed relay
4. 7.5A fuse for compressor coupling

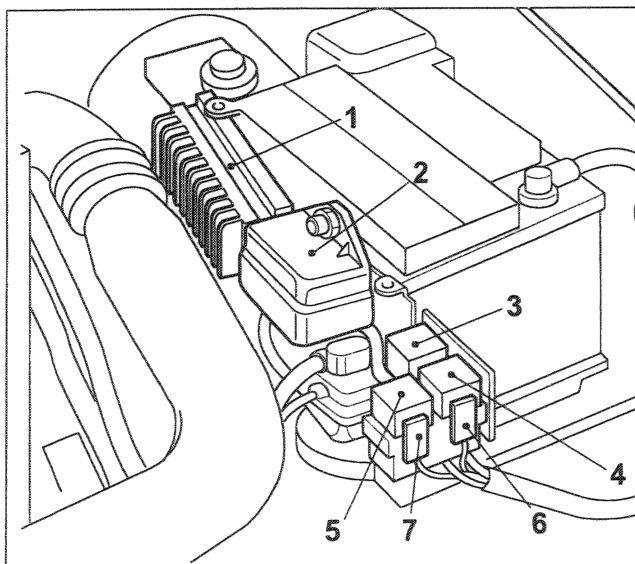

P3M03XL03



LOCATION OF CONTACTORS, FUSES AND CONTROL UNITS IN ENGINE BAY

1697 TD engine:

1. Anti-pollution device (E.G.R.) electronic control unit
2. Plug preheating electronic control unit
3. Relay for heated fuel filter device
4. Relay for diesel fuel system
5. Relay controlling air conditioner compressor
6. 20A fuse protecting heated fuel filter
7. 10A fuse protecting anti-lock braking system (A.B.S.)