

PUNTO eMANUAL

Bodywork

| Title | Page |
|--------------------------------------------------|------|
| Removing/refitting electric window | 1 ➡ |
| Removing/refitting motor | 2 ➡ |
| Removing/refitting front electric controls | 3 ➡ |
| Removing/refitting rear electric controls | 4 ➡ |
| Wiring diagram | 5 ➡ |

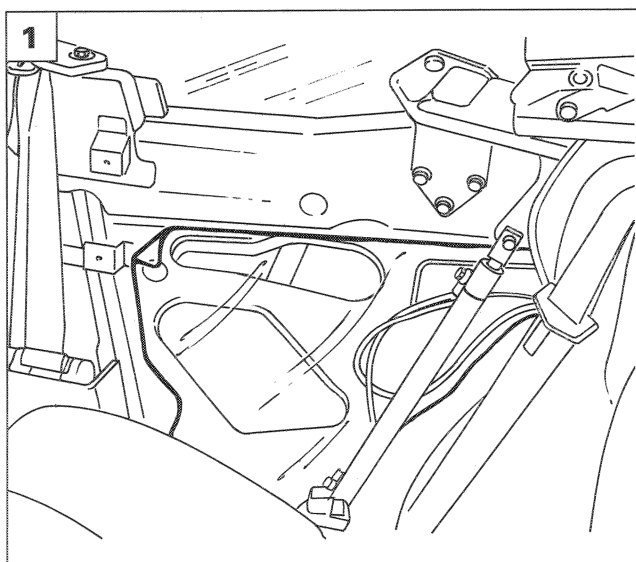

P3M91BM01

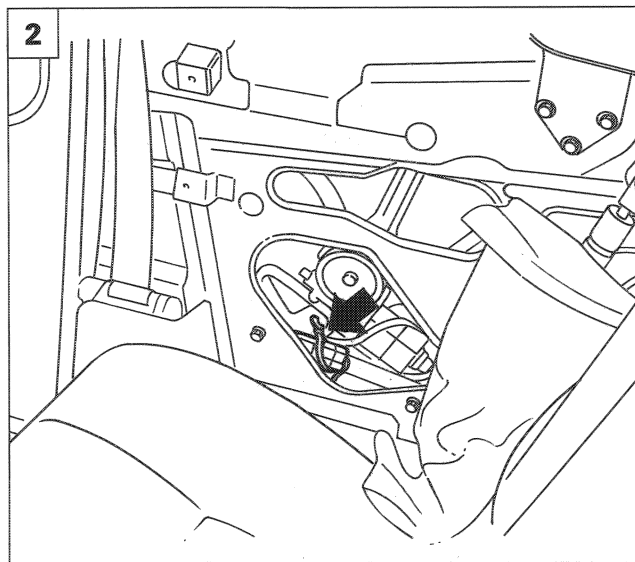
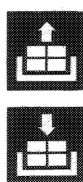

P3M91BM02

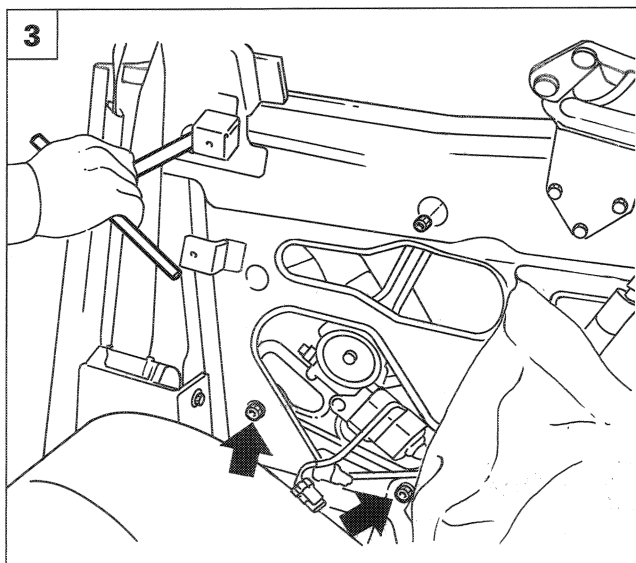

P3M91BM03

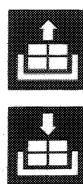

REMOVING-REFITTING ELECTRIC WINDOW

Remove the inner lining as described on pages 1 - 4 of section 70 Bodywork in the Punto Cabrio manual (print no. 506.003/02), then proceed as described below.

NOTE Place the window in the closed position.

1. Partly unstick the plastic protection.
2. Remove the fixing band and disconnect the connector from the electric window motor.
3. Undo the nuts fixing the electric window device to the bodyshe'll.
4. Move the outer glass scraper trim aside.
5. Extract the device complete with window.

NOTE To refit suitably reverse the operations carried out for the removal.

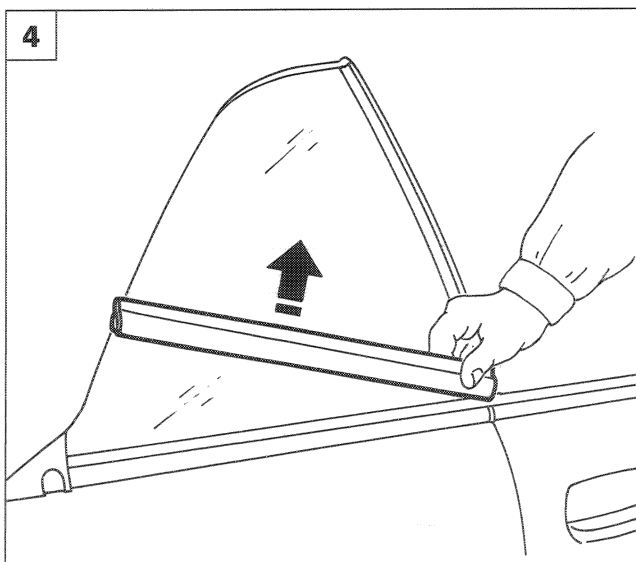

P3M91BM04

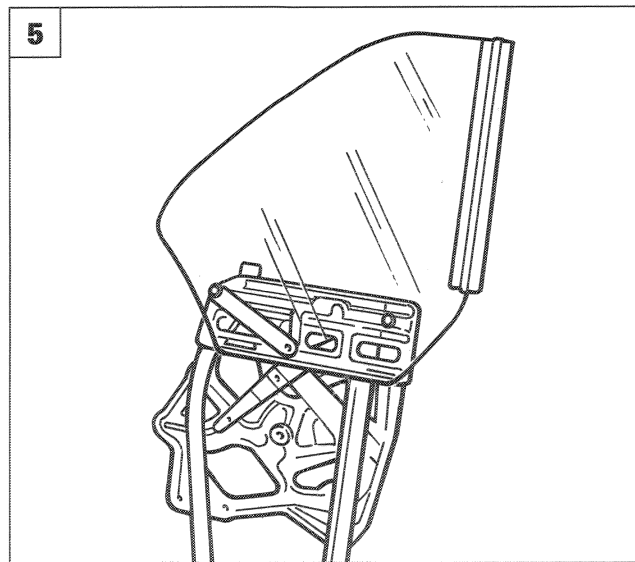
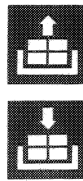

P3M91BM05

70.

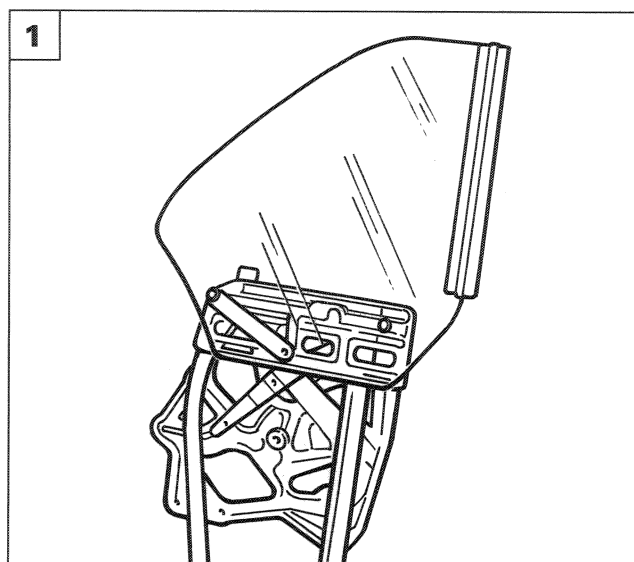

P3M91BM05



REMOVING-REFITTING ELECTRIC WINDOW MOTOR

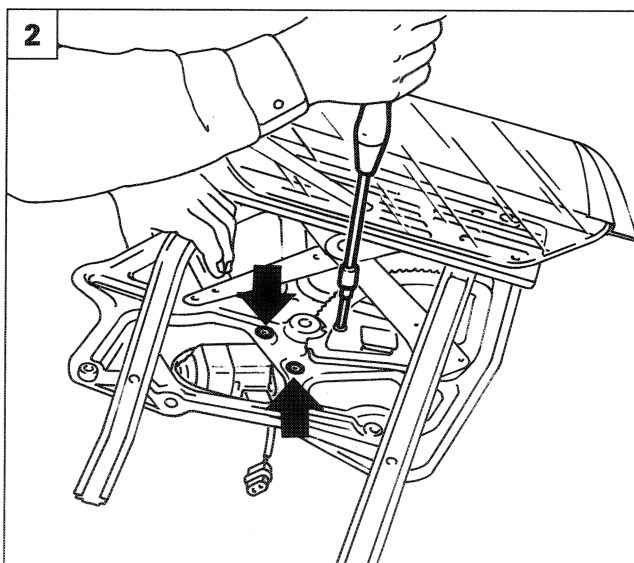

P3M92BM01



Order of operations

1. Remove the electric window device from the vehicle as described on page 91.
2. Undo the bolts fixing the operating motor to the electric window.
3. Remove the motor from its housing.
4. Electric window motor.

NOTE *To refit suitably reverse the operations carried out for the removal.*

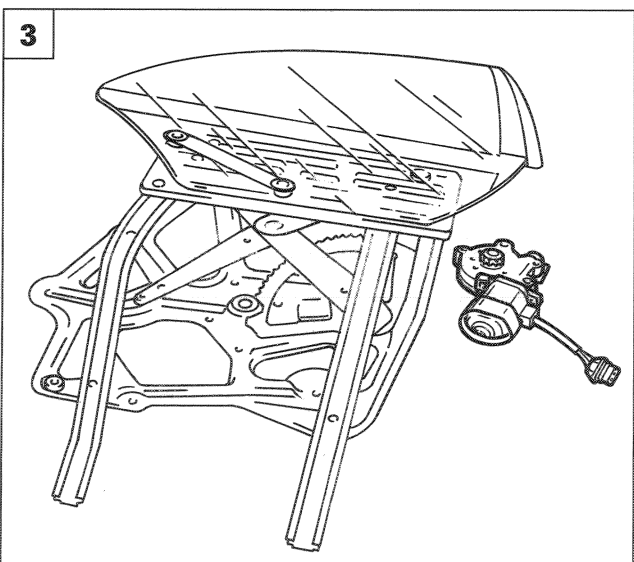

P3M92BM02

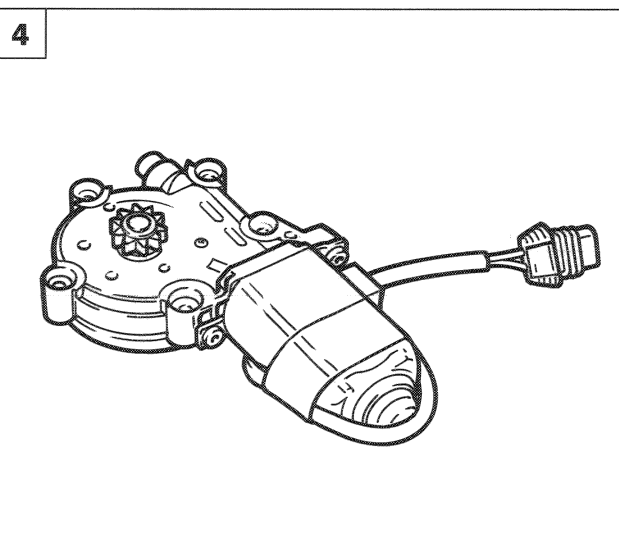

P3M92BM03

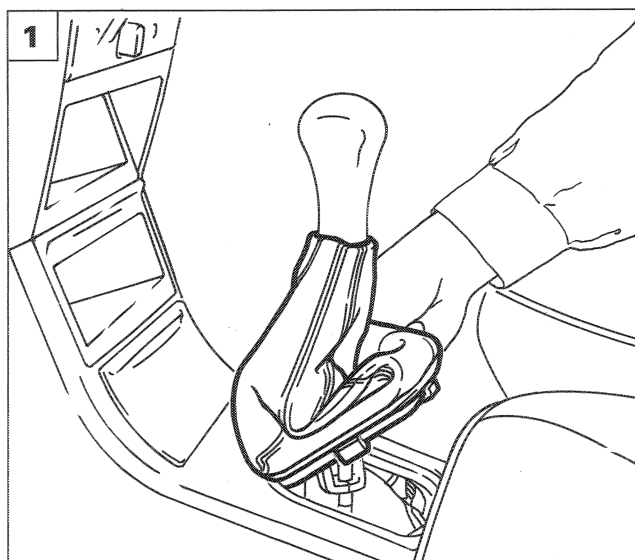

P3M93BM01

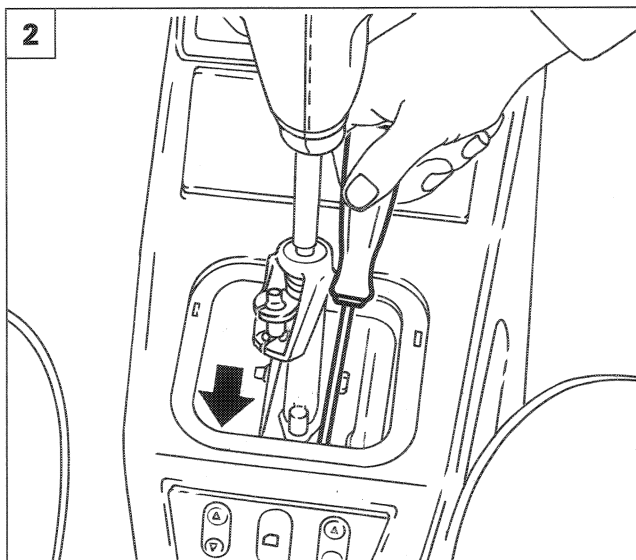
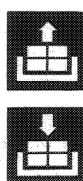

P3M93BM02

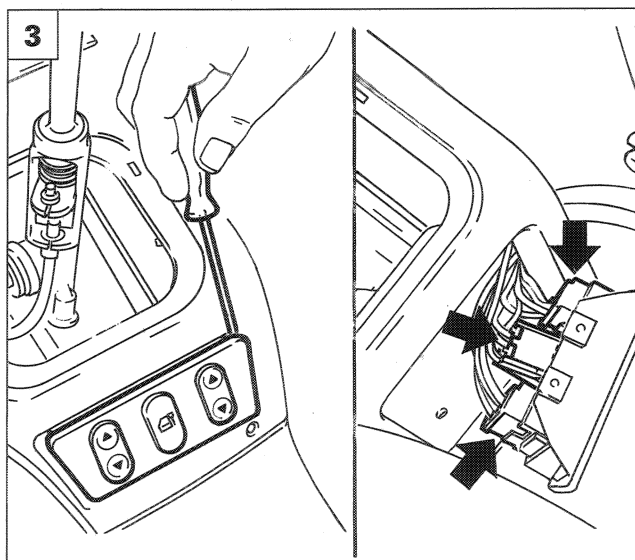

P3M93BM03

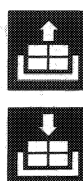

REMOVING-REFITTING FRONT ELECTRIC WINDOW CONTROL

1. Remove the protective boot for the gear engagement selector lever.
2. Undo the bolts fixing the control panel to the tunnel cover.
3. Extract the control panel from its housing and disconnect the connectors shown in the diagram;.
4. Acting on the retaining tabs, remove the control button from its housing.
5. Electric window control button.

NOTE To refit suitably reverse the operations carried out for the removal.

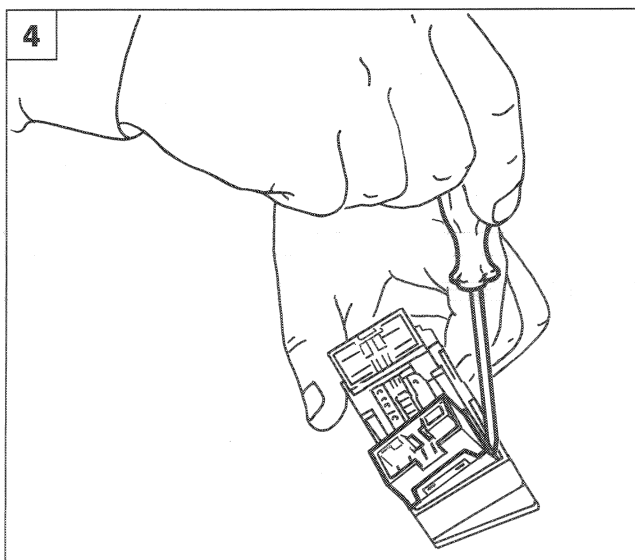

P3M93BM04

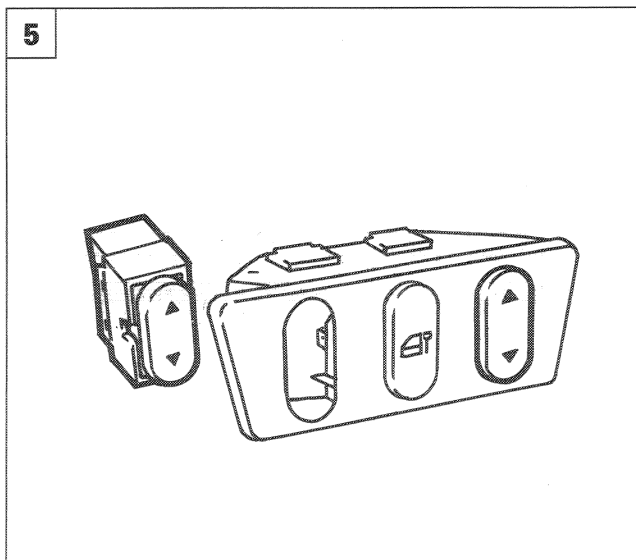
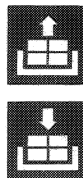

P3M93BM05

70.

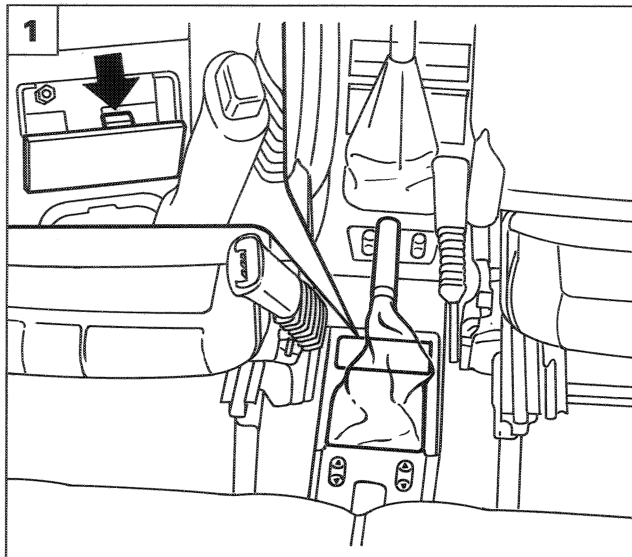

P3M94BM01

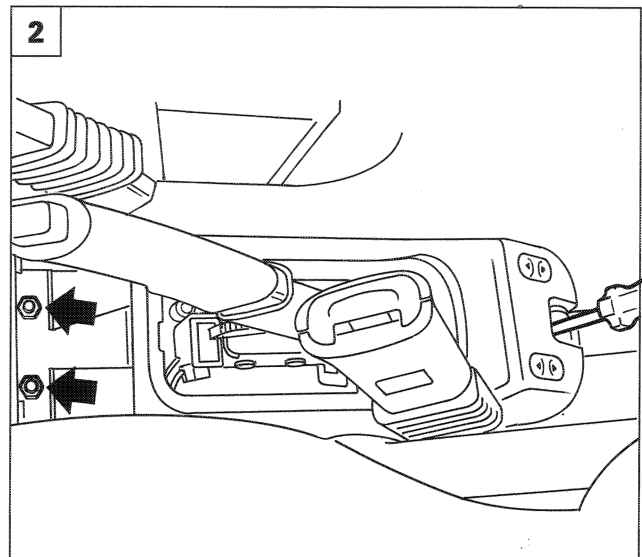
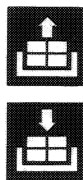

P3M94BM02

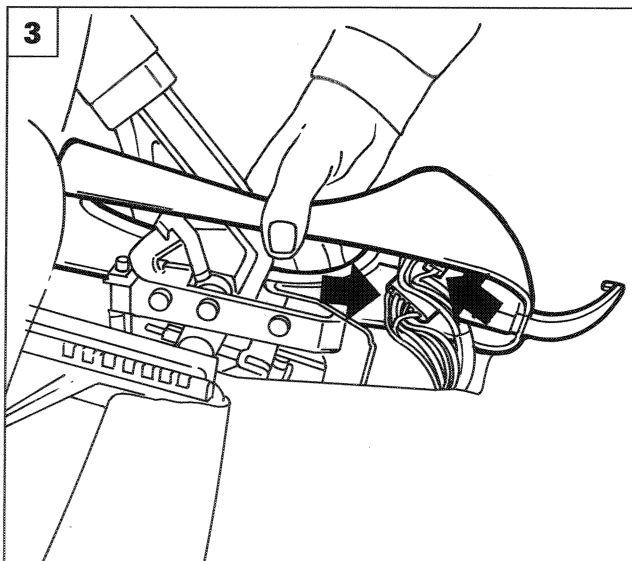

P3M94BM03

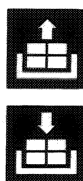

REMOVING-REFITTING REAR ELECTRIC WINDOW CONTROL BUTTON

1. Remove the protective boot for the hand-brake lever then, acting on the retaining tab, remove the cowling as shown in the inset.
2. Lift up the cowling and undo the nuts fixing the tunnel cover.
3. Disconnect the connectors shown in the diagram and remove the tunnel cover complete with control panel
4. Undo the bolts shown and remove the control panel from the tunnel cover.
5. Acting on the retaining tabs, remove the control button from its housing.

NOTE To refit suitably reverse the operations carried out for the removal.

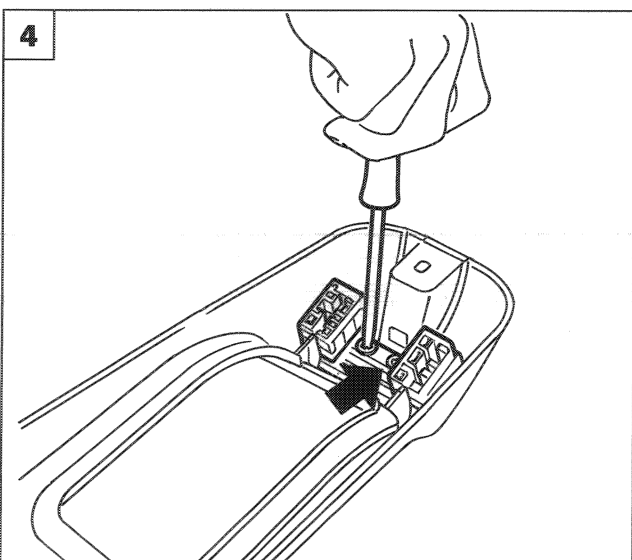

P3M94BM04

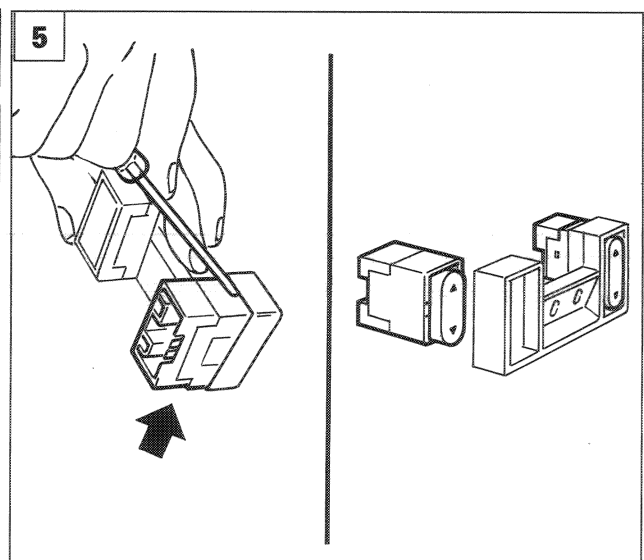
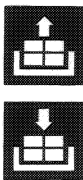

P3M94BM05

WIRING DIAGRAM (see components key on page 97)

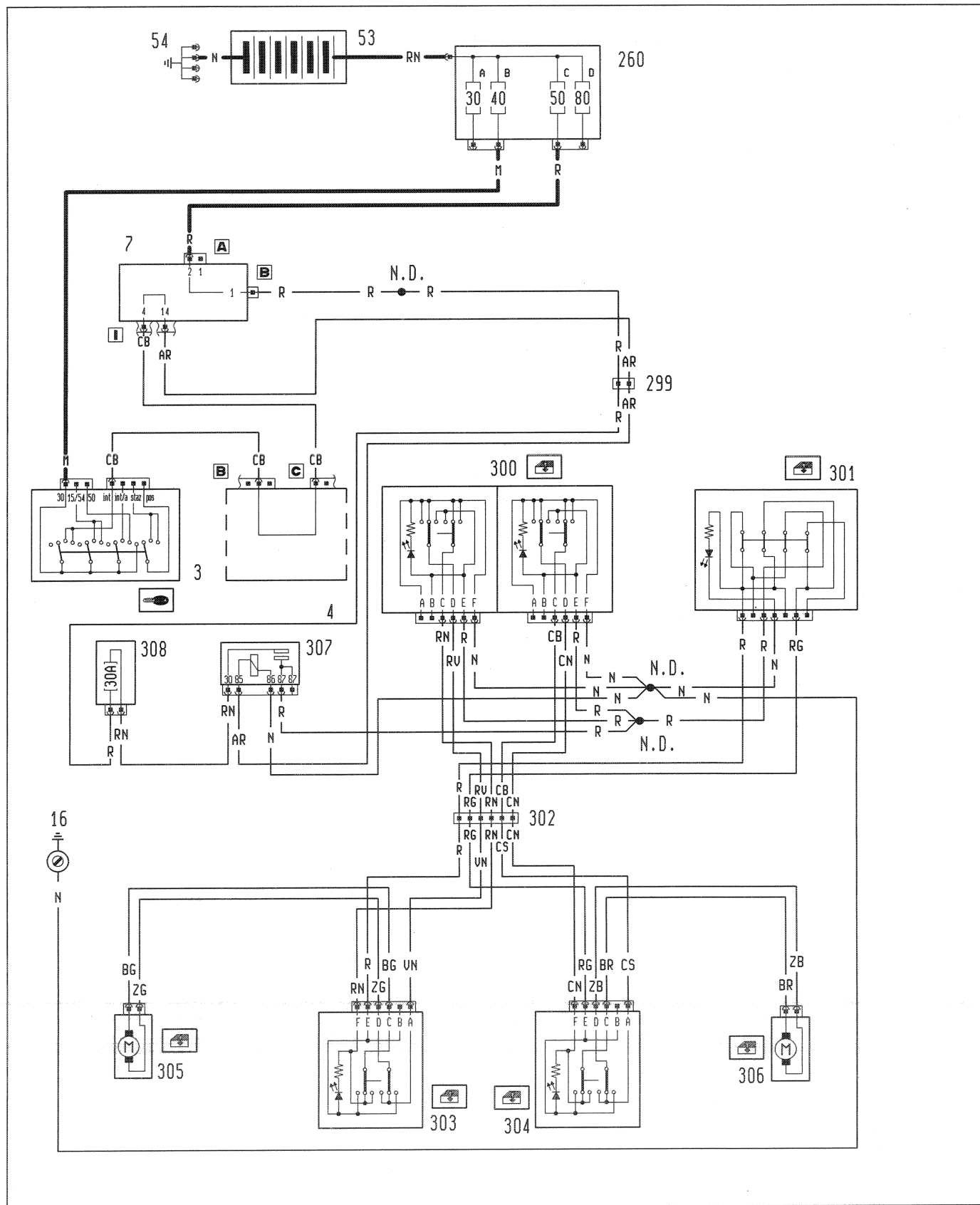

P3M95BM01

70.

WIRING DIAGRAM (see components key on page 97)

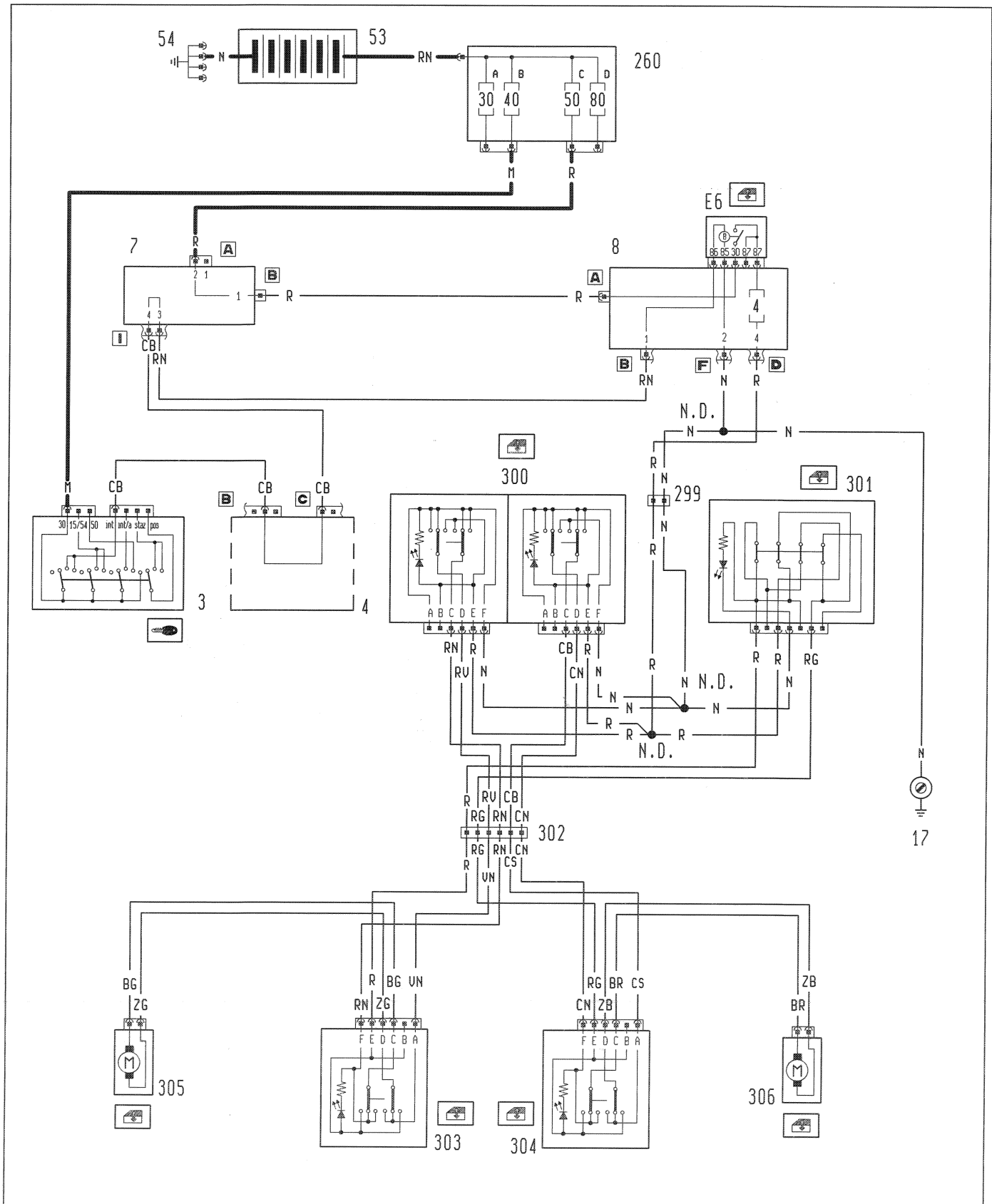

P3M96BM01

COMPONENTS KEY

- 3. Ignition switch
- 4. Steering column switch unit
- 7. Junction unit
- 8. Optional control unit
 - E6. Power relay (sun roof)/electric rear windows
- 16. Left dashboard earth
- 17. Right dashboard earth
- 53. Battery
- 54. Earth for battery
- 260. Power fuse box
 - A. 30A fuse protecting injection system
 - B. 40A protective fuse for ignition system
 - C. 50A fuse protecting supplementary devices system
 - D. 80A protective fuse for junction unit
- 299. Connection between dashboard and electric rear windows cables
- 300. Rear electric windows control panel on centre console
- 301. Rear electric windows inhibitor button on centre console
- 302. Connection between dashboard/rear cables
- 303. Left rear electric window control button on gear lever panel
- 304. Right rear electric window control button on gear lever panel
- 305. Left rear electric window motor
- 306. Right rear electric window motor
- 307. Rear electric windows relay feed
- 308. 30A fuse protecting electric rear windows